

HCG - HORN Catalog Guide

Bore Ø	Product line								
	105	110	108	10P	111	11P	114	116	18P
≥ .008" (0.2 mm)	•								
≥ .236" (6.0 mm)	•	•							
≥ .268" (6.8 mm)	•	•							
≥ .307" (7.8 mm)		•	•						
≥ .315" (8.0 mm)		•	•						
≥ .346" (8.8 mm)				•					
≥ .354" (9.0 mm)		•	•	•					
≥ .386" (9.8 mm)					•	•			
≥ .394" (10.0 mm)		•		•	•				
≥ .419" (10.5 mm)						•			
≥ .433" (11.0 mm)					•	•			
≥ .492" (12.5 mm)							•		
≥ .551" (14.0 mm)							•	•	
≥ .630" (16.0 mm)								•	
≥ .650" (16.5 mm)							•		
≥ .689" (17.5 mm)									•

Groove depth ≤ (inch)	.098"	.157"	.039"	.118"	.091"	.138"	.256"	.169"	.315"
Groove depth ≤ (mm)	2.5	4.0	1.0	3.0	2.3	3.5	6.5	4.3	8.0
Width of groove inch	.020"-.079"	.039"-.250"	.029"-.079"	.039"-.118"	.029"-.125"	.039"-.118"	.029"-.125"	.029"-.157"	.071"-.118"
Width of groove mm	0.5 - 2.0	1.0 - 6.35	0.74 - 2.0	1.0 - 3.0	0.74 - 3.18	1.0 - 3.0	0.74 - 3.18	0.74 - 4.0	1.8 - 3.0

Application	Product line								
	105	110	108	10P	111	11P	114	116	18P
Grooving	•	•	•	•	•	•	•	•	•
Boring	•	•	•	•	•	•	•	•	•
Threading	•		•		•		•	•	
Chamfering	•		•		•		•	•	
Face Grooving	•	•					•		
Hard turning	•		•		•		•	•	

Chapter	A	B	C	D	E	F	G	H	J
---------	----------	----------	----------	----------	----------	----------	----------	----------	----------

Special tools upon request

Supermini® CARBIDE GROOVING TOOLS

BU/B110, VDI...110
N79IK
 Toolholder



Page B2-B4



Page B5-B6



Page B7

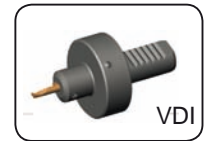

Page B8



Page B9

U110 / 110
 $\geq \text{Ø } .236'' (6.0 \text{ mm})$
 Inserts

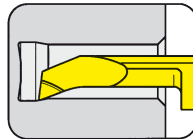

Page B10

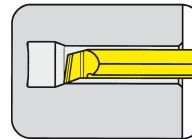

Page B11

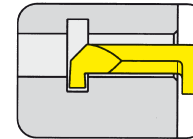

Page B12-B18

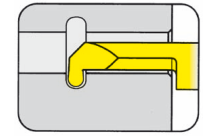

Page B20-B21

BU110 / B110
 Face Grooving
 Toolholder



Page B22-B23

A110
 Face Grooving
 Inserts

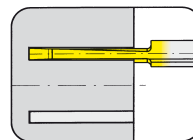

Page B24

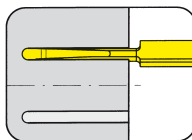

Page B25

B

TOOLHOLDER Type

BU110

with through coolant supply

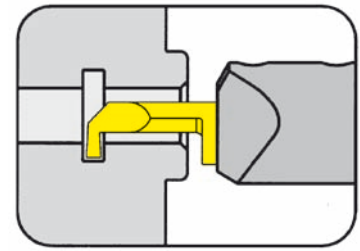

Bore Ø from	.236"
Depth of groove up to	.157"
Width of groove up to	.250"

for use with Insert

Type 110
U110

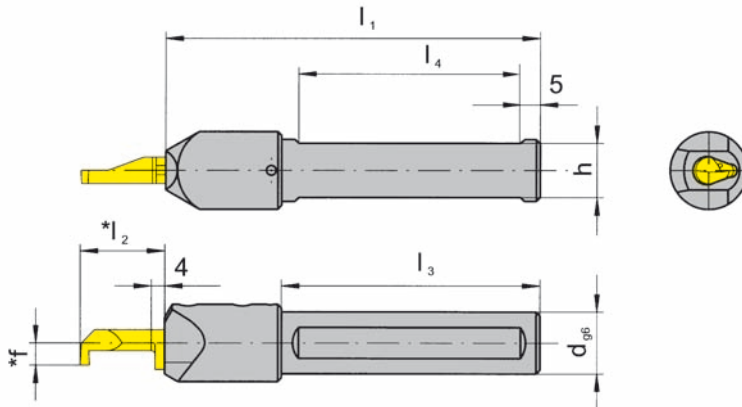

Picture = right hand cutting version shown

Part number	d	l ₁	h	l ₃	l ₄
BU110.0625.02	.625	3.937	.551	2.756	2.165
BU110.0750.02	.750	3.937	.709	-	2.165

Further sizes upon request

f, l₂ see inserts type 110

Dimensions in inch

Ordering note:

Toolholders can be used with right and left hand inserts.

Spare parts

Toolholder	Screw	TORX PLUS® Wrench
BU110.0...	6.075T15P	T15PQ

TOOLHOLDER Type

B110

with through coolant supply

Bore Ø from	.236" (6.0 mm)
Depth of groove up to	.157" (4.0 mm)
Width of groove up to	.250" (6.35 mm)

Extended depth of insert seat

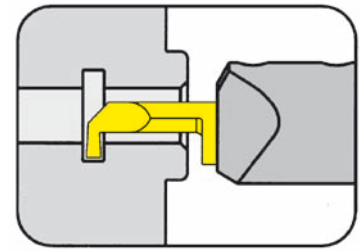

for use with Insert

Type 110
U110

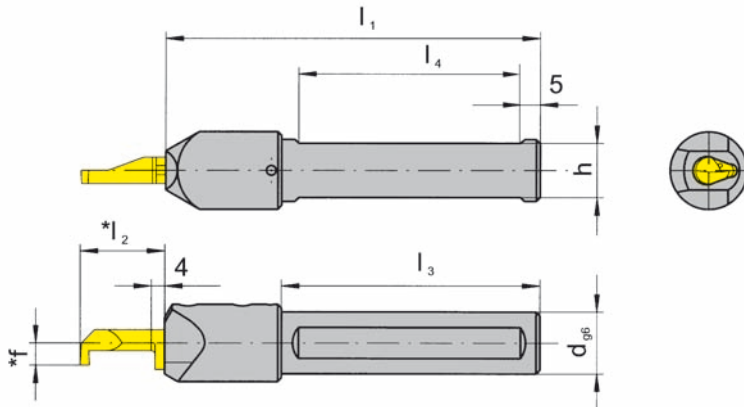

Picture = right hand cutting version shown

Part number	d	l ₁	h	l ₃	l ₄
B110.0016.02	16	100	14	70	55
B110.0020.02	20	100	18	-	55
B110.0022.02	22	100	20	-	55
B110.0025.02	25	100	23	-	55

Further sizes upon request

f, l₂ see inserts type 110

Dimensions in mm

Ordering note:

Toolholders can be used with right and left hand inserts.

Spare parts

Toolholder	Screw	TORX PLUS® Wrench
B110.00...	6.075T15P	T15PQ

B

TOOLHOLDER Type

B110

with through coolant supply

Bore Ø from	.236" (6.0 mm)
Depth of groove up to	.157" (4.0 mm)
Width of groove up to	.250" (6.35 mm)

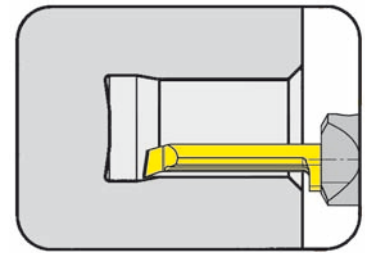

for use with Insert

Type 110
U110

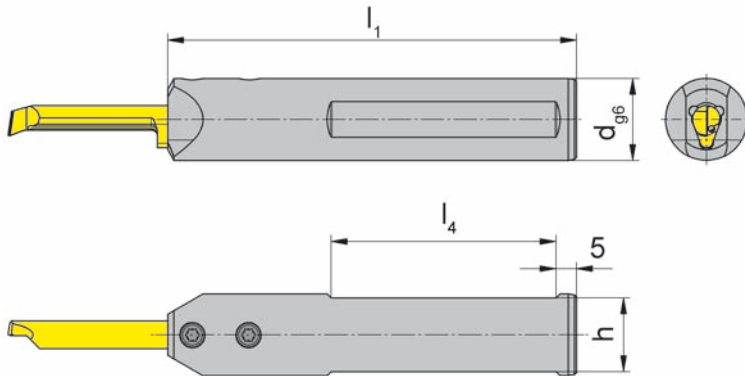

Picture = right hand cutting version shown

with additional through coolant bores

Part number	d	l ₁	h	l ₄
B110.0020.K.02	20	100	18	55

Further sizes upon request

f, L see inserts type 110

Dimensions in mm

Ordering note:

Toolholders can be used with right and left hand inserts.

Spare parts

Toolholder	Screw	TORX PLUS® Wrench
B110.0020.K.02	6.075T15P	T15PQ

B4

TOOLHOLDER Type

B110C

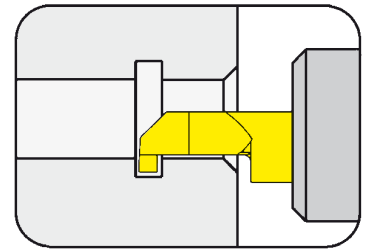

Adapter for inserts type 110 HORN-Capto

for use with Insert

Type 110
U110

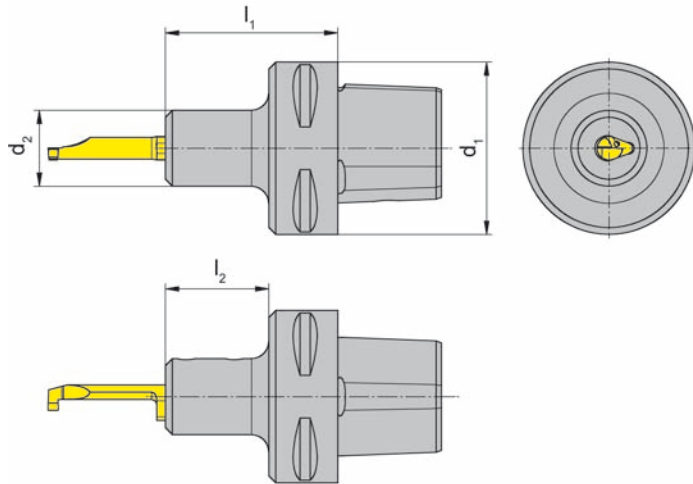

R = right hand version shown

L = left hand version

Licence Sandvik

Part number	l_1	l_2	d_2	d_1	Remark
R/LB110.00C5.22.1.02	50	30	22	50	C5

Further sizes upon request

Dimensions in mm

Spare parts

Toolholder	Screw	TORX PLUS® Wrench
R/LB110.00C5.22.1.02	6.075T15P	T15PQ

TOOLHOLDER Type

B110C

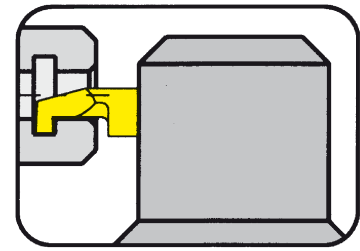

Adapter for inserts type 110 HORN-Capto

for INDEX Multi spindle machines

for use with Insert

Type 110
U110

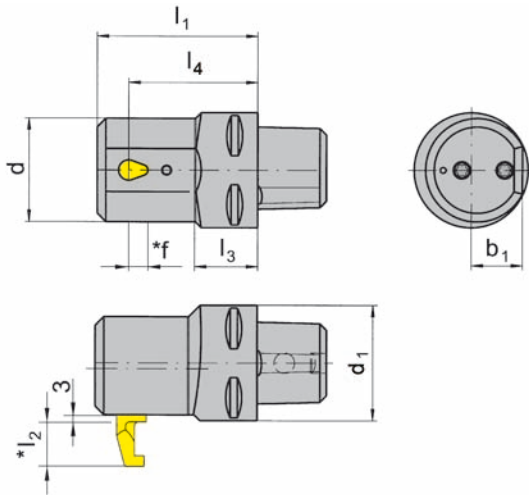

Picture = right hand cutting version shown

Licence Sandvik

Part number	d	l ₁	l ₃	b ₁	l ₄	d ₁	Remark	Type of machine
RB110.00C3.2.2.02	36	56	15	18	45	32	C3	MS32
RB110.00C4.2.2.02	36	56	22	18	45	40	C4	MS52

Further sizes upon request

f, l₂ see inserts type 110

Dimensions in mm

Spare parts

Toolholder	Screw	TORX PLUS® Wrench
RB110.00C...	6.075T15P	T15PQ

TOOLHOLDER Type

B110KM

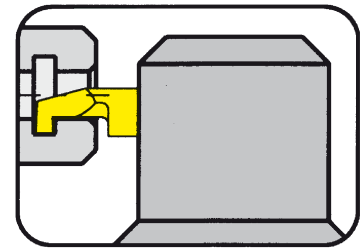

Adapter for inserts type 110 HORN-KM

for INDEX Multi spindle machines

for use with Insert

Type 110
U110

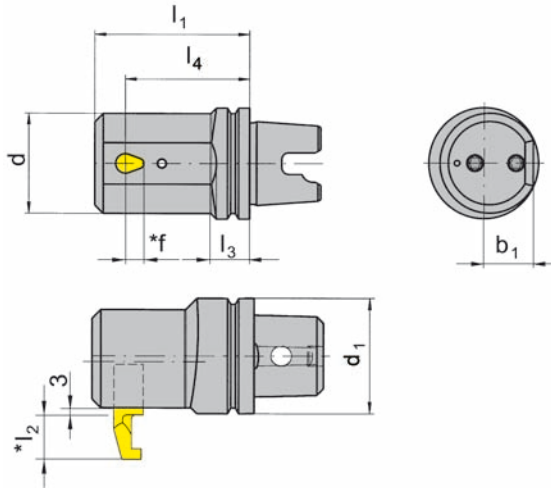

Picture = right hand cutting version shown

Licence Kennametal

Part number	d	l ₁	l ₃	b ₁	l ₄	d ₁	Type of machine
RB110.KM40.2.2.02	36	56	14	18	45	40	MS32
RB110.KM50.2.2.02	36	56	22	18	45	50	MS52

Further sizes upon request

f, l₂ see inserts type 110

Dimensions in mm

Spare parts

Toolholder	Screw	TORX PLUS® Wrench
RB110.KM...	6.075T15P	T15PQ

B

TOOLHOLDER Type

VDI

with through coolant supply

Bore Ø from .236" (6.0 mm)

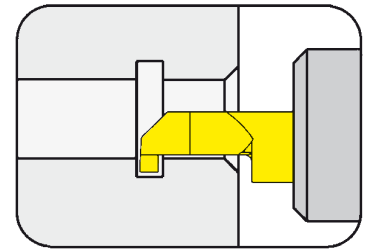

for use with Insert

Type 110
U110

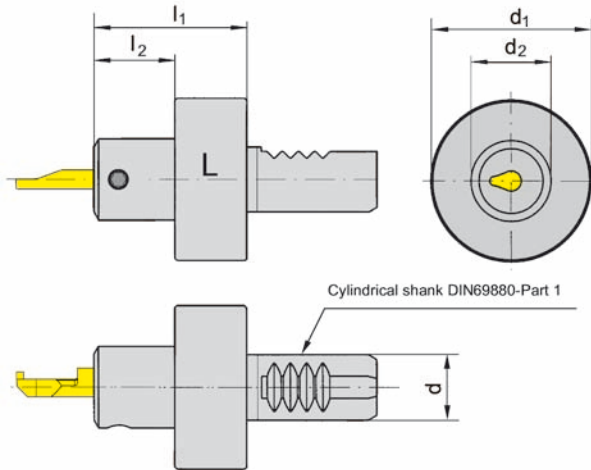

L = left hand version shown

R = right hand version

Part number	d	l ₁	l ₂	d ₂	d ₁
VDI16.R/L110.30.02	16	48	30	22	40
VDI20.R/L110.30.02	20	48	30	22	50
VDI25.R/L110.30.02	25	48	30	22	58
VDI30.R/L110.30.02	30	48	30	22	68

State R or L version

Dimensions in mm

Further sizes upon request

Spare parts

Toolholder	Screw	TORX PLUS® Wrench
VDI...	6.075T15P	T15PQ

ADJUSTABLE HOLDER Type

N



B

Bore Ø from	.236" (6.0 mm)
Depth of groove up to	.157" (4.0 mm)
Width of groove up to	.250" (6.35 mm)

with through coolant supply

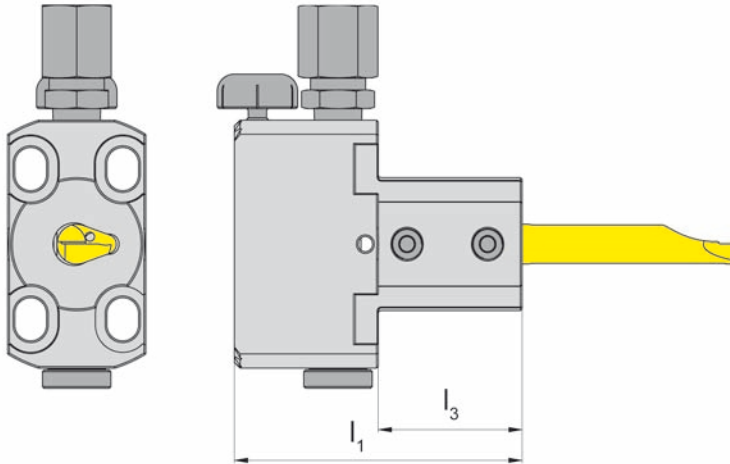

for use with Insert

Type 110
U110

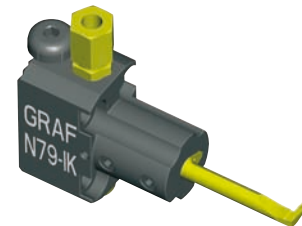

Picture = right hand cutting version shown

Part number	l_1	l_3
N79IK	50	25

Further sizes upon request

Dimensions in mm

Spare parts

Adjustable holder	Screw	Height adjustment screw	Coolant supply
N79IK	6.075T15P	002.00.69	004.00.19

INSERT Type

110

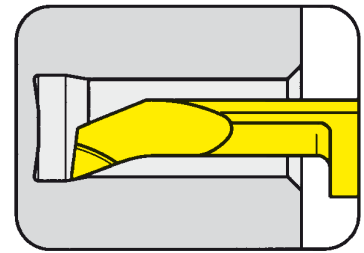

Bore Ø from .236''

for use with Toolholder

Type BU110
B110
B110C
VDI

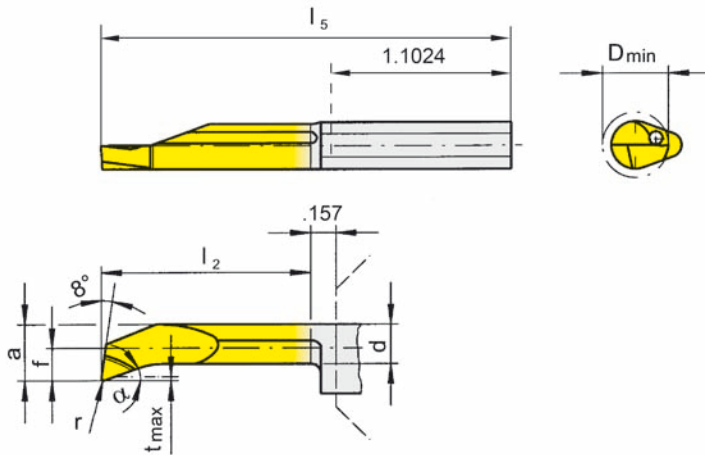

R = right hand version shown

L = left hand version

Part number	f	a	d	l ₂	l ₅	t _{max}	D _{min}	r	Carbide grades				
									MG12	TN35	TI25	TF45	TH35
R/L110.1829.7.6	.114	.224	.189	1.575	2.756	.020	.236	.008			▲▲		▲▲
R/L110.1829.9.6											▲▲		▲▲
R/L110.1829.9.8	.157	.291	.236	1.969	3.150	.020	.315	.008			▲/▲		▲/▲
▲ on stock Δ 4 weeks ● main recommendation ○ alternative recommendation □ uncoated grades ■ coated grades ■ brazed/Cermet									P		●		●
									M		●		●
									K		●		●
									S		●		●
									N		●		●
									H				

Dimensions in inch

State R or L version

INSERT Type

110

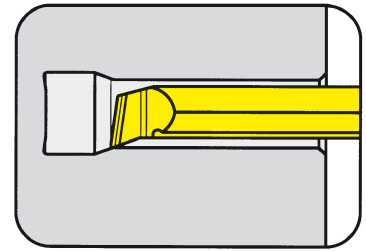

Bore Ø from .236''

for use with Toolholder

Type BU110
B110
B110C
VDI

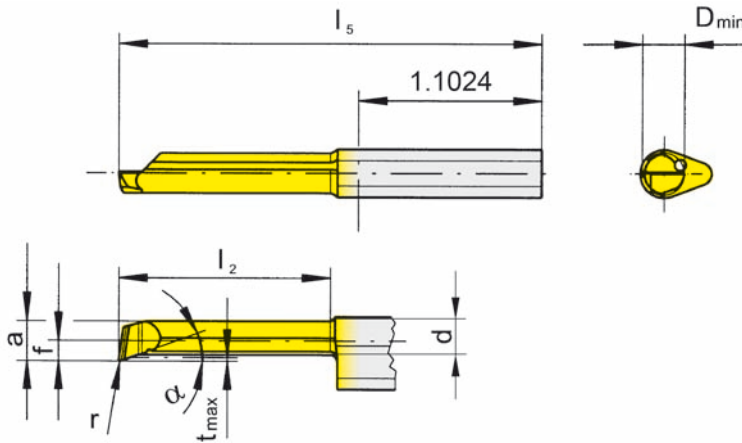

R = right hand version shown

with chip breaker
(geometry H)

Part number	f	a	d	l ₂	l ₅	t _{max}	D _{min}	r	Carbide grades				
									MG12	TN35	TI25	TF45	TH35
R110.1829.9.H6	.114	.224	.189	1.969	3.150	.020	.236	.008			Δ		
R110.1829.9.H8	.157	.291	.236	1.969	3.150	.020	.315	.008			Δ		
									P		•		
									M		•		
									K		•		
									S		•		
									N		•		
									H				

- ▲ on stock Δ 4 weeks
- main recommendation
- o alternative recommendation
- uncoated grades
- coated grades
- brazed/Cermet

Dimensions in inch

Carbide grades

GROOVING (internal) $\geq \text{Ø} .315''$



B

INSERT Type

110

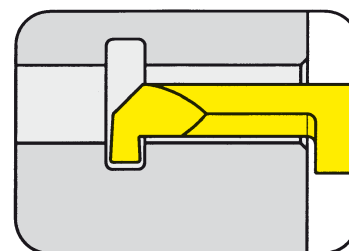

Bore Ø from $.315''$
 Depth of groove up to $.110''$

for use with Toolholder

Type BU110
 B110
 B110C
 VDI

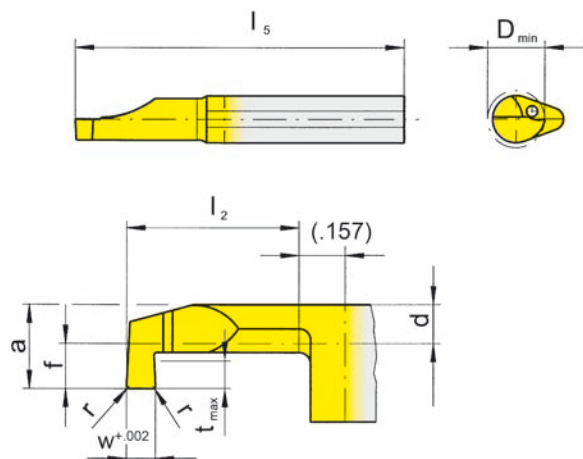

R = right hand version shown

with corner radius

Part number	w	f	a	d	l_2	l_5	t_{max}	D_{min}	r	MG12	TN35	TI25	TF45	TH35
R110.0200.02.3.8	.079	.157	.291	.165	.787	1.969	.110	.315	.008		▲			
										P	•			
										M	•			
										K	•			
										S	•			
										N	•			
										H				

Carbide grades

- ▲ on stock Δ 4 weeks
- main recommendation
- o alternative recommendation
- uncoated grades
- coated grades
- brazed/Cermet

Dimensions in inch

GROOVING (internal) $\geq \text{Ø} .315''$



INSERT Type

110

B

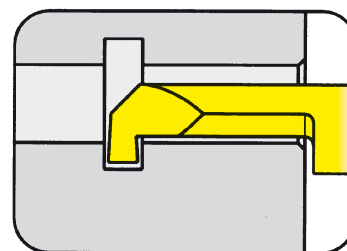

Bore Ø from $.315''$
Depth of groove up to $.157''$

for use with Toolholder

Type BU110
B110
B110C
VDI

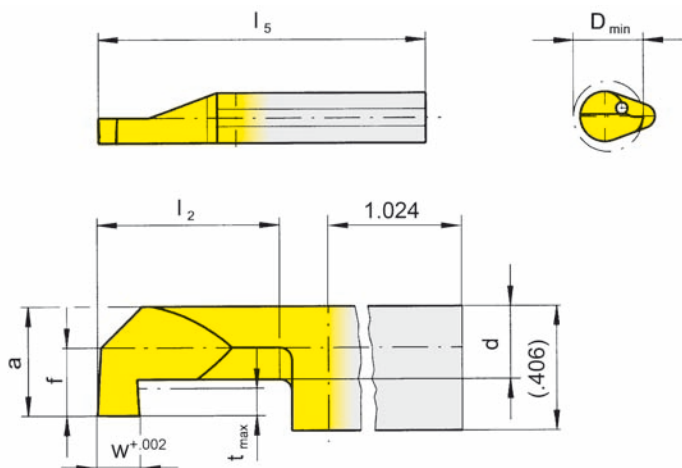

R = right hand version shown

L = left hand version

Part number	w	f	a	d	l ₂	l ₅	t _{max}	D _{min}	Carbide grades					
									MG12	TN35	TI25	TF45	TH35	
R/L110.0100.5.8	.039									▲/▲				
R/L110.0200.5.8	.079	.157	.291	.165	1.181	2.362	.110	.315		▲/▲				
R/L110.0250.5.8	.098									▲/▲				
R/L110.0100.7.8	.039									▲/Δ				
R/L110.0200.7.8	.079	.157	.291	.165	1.575	2.756	.110	.315		▲/▲				
R/L110.0250.7.8	.098									▲/Δ				
R/L110.0100.5.0	.039									▲/Δ				
R/L110.0200.5.0	.079	.236	.370	.197	1.181	2.362	.157	.394		▲/▲				
R/L110.0300.5.0	.118									▲/▲				
R/L110.0100.9.0	.039									▲/▲				
R/L110.0200.9.0	.079	.236	.370	.197	1.969	3.150	.157	.394		▲/▲				
R/L110.0300.9.0	.118									▲/Δ				
										P	•			
										M	•			
										K	•			
										S	•			
										N	•			
										H				

- ▲ on stock Δ 4 weeks
- main recommendation
- o alternative recommendation
- uncoated grades
- coated grades
- brazed/Cermet

Dimensions in inch

State R or L version

Carbide grades

GROOVING (internal) $\geq \text{Ø} .315''$



B

INSERT Type

U110

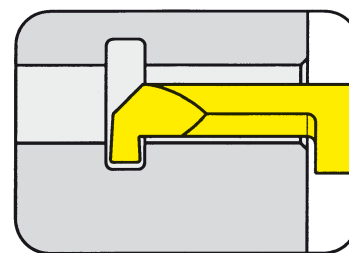

Bore Ø from $.315''$
Depth of groove up to $.110''$

for use with Toolholder

Type BU110
B110
B110C
VDI

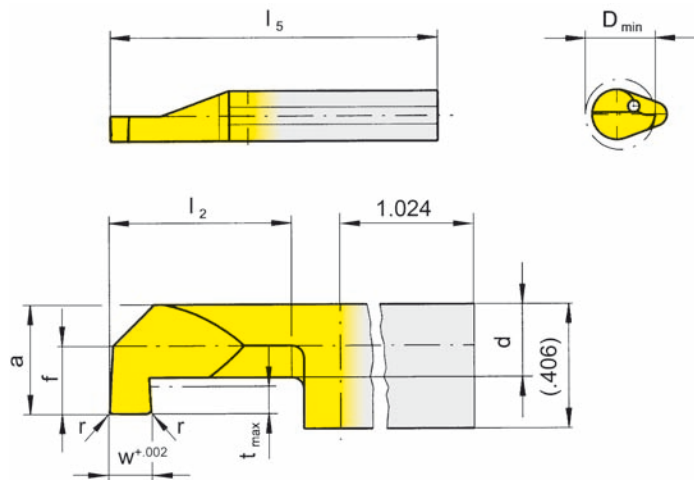

R = right hand version shown

L = left hand version

with corner radius

Part number	w	f	a	d	l ₂	l ₅	t _{max}	D _{min}	r	Carbide grades				
										MG12	TN35	TI25	TF45	TH35
R/LU110.4608.3.8	.046											▲/		
R/LU110.6208.3.8	.062											▲/		
R/LU110.7808.3.8	.078											▲/		
R/LU110.9408.3.8	.094	.157	.291	.165	.787	1.969	.110	.315	.008			▲/		
R/LU110.1208.3.8	.125											▲/Δ		
R/LU110.2508.3.8	.250											▲/		
R/LU110.4608.7.8	.046											▲/		
R/LU110.6208.7.8	.062											▲/Δ		
R/LU110.7808.7.8	.078											▲/		
R/LU110.9408.7.8	.094	.157	.291	.165	1.575	2.756	.110	.315	.008			▲/		
R/LU110.1208.7.8	.125											▲/		
R/LU110.2508.7.8	.250											▲/		
											P	•		
											M	•		
											K	•		
											S	•		
											N	•		
											H			

- ▲ on stock Δ 4 weeks
- main recommendation
- o alternative recommendation
- uncoated grades
- coated grades
- brazed/Cermet

Dimensions in inch
State R or L version

Carbide grades

GROOVING (internal) $\geq \text{Ø} .315''$



B

INSERT Type

U110

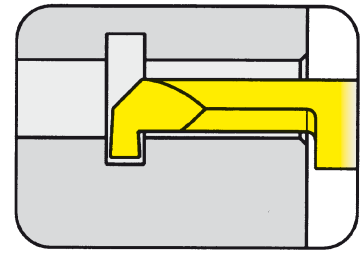

Bore Ø from .315''
 Depth of groove up to .110''

for use with Toolholder

Type BU110
 B110
 B110C
 VDI

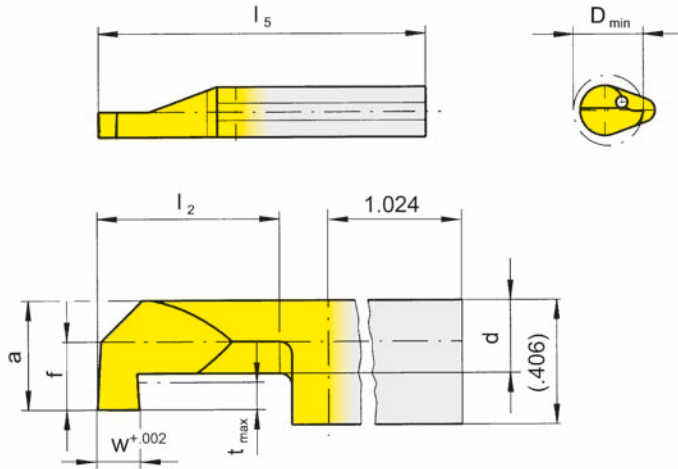

R = right hand version shown

L = left hand version

Part number	w	f	a	d	l ₂	l ₅	t _{max}	D _{min}	Carbide grades					
									MG12	TN35	TI25	TF45	TH35	
R/LU110.0046.3.8	.046										▲/			
R/LU110.0062.3.8	.062										▲/▲			
R/LU110.0078.3.8	.078										▲/			
R/LU110.0094.3.8	.094	.157	.291	.165	.787	1.969	.110	.315			▲/▲			
R/LU110.0125.3.8	.125										▲/			
R/LU110.0250.3.8	.250										▲/			
R/LU110.0046.7.8	.046										▲/			
R/LU110.0062.7.8	.062										▲/			
R/LU110.0078.7.8	.078										▲/			
R/LU110.0094.7.8	.094	.157	.291	.165	1.575	2.756	.110	.315			▲/			
R/LU110.0125.7.8	.125										▲/			
R/LU110.0250.7.8	.250										▲/			
▲ on stock Δ 4 weeks ● main recommendation ○ alternative recommendation □ uncoated grades ■ coated grades ■ brazed/Cermet										P		●		
										M		●		
										K		●		
										S		●		
										N		●		
										H				

Dimensions in inch

Carbide grades

State R or L version

GROOVING (internal) $\geq \text{Ø} .394''$



B

INSERT Type

U110

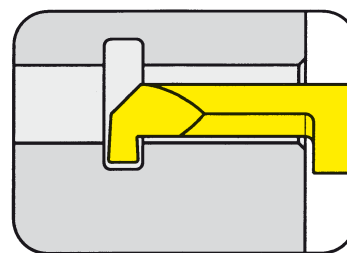

Bore Ø from .394''
 Depth of groove up to .157''

for use with Toolholder

Type BU110
 B110
 B110C
 VDI

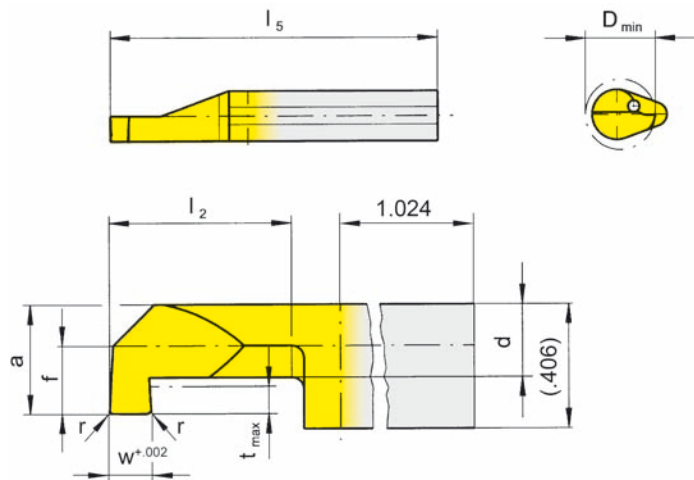

R = right hand version shown

L = left hand version

with corner radius

Part number	w	f	a	d	l ₂	l ₅	t _{max}	D _{min}	r	Carbide grades				
										MG12	TN35	TI25	TF45	TH35
R/LU110.4608.3.0	.046											▲/		
R/LU110.6208.3.0	.062											▲/▲		
R/LU110.7808.3.0	.078											▲/		
R/LU110.9408.3.0	.094	.236	.370	.197	.787	1.969	.157	.394	.008			▲/		
R/LU110.1208.3.0	.125											▲/Δ		
R/LU110.2508.3.0	.250											▲/▲		
R/LU110.4608.7.0	.046											▲/		
R/LU110.6208.7.0	.062											▲/		
R/LU110.7808.7.0	.078											▲/		
R/LU110.9408.7.0	.094	.236	.370	.197	1.575	2.756	.157	.394	.008			▲/		
R/LU110.1208.7.0	.125											▲/		
R/LU110.2508.7.0	.250											▲/		
											P	•		
											M	•		
											K	•		
											S	•		
											N	•		
											H			

- ▲ on stock Δ 4 weeks
- main recommendation
- o alternative recommendation
- uncoated grades
- coated grades
- brazed/Cermet

Dimensions in inch
 State R or L version

Carbide grades

B16

GROOVING (internal) $\geq \text{Ø } .394''$



B

INSERT Type

U110

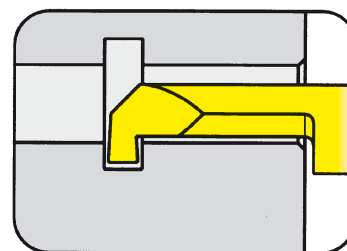

Bore Ø from .394''
 Depth of groove up to .157''

for use with Toolholder

Type BU110
 B110
 B110C
 VDI

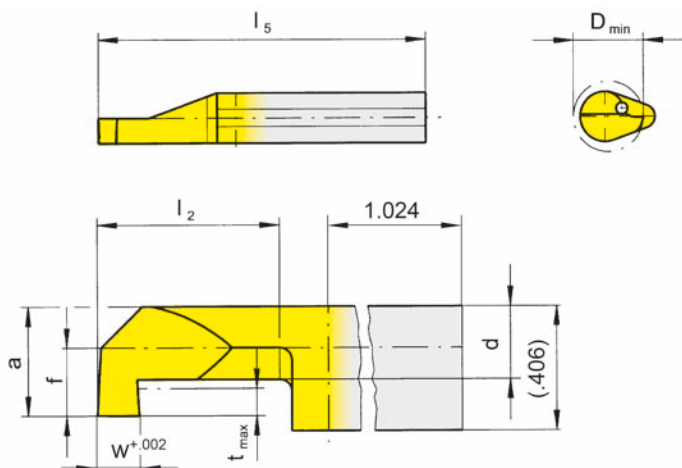

R = right hand version shown

L = left hand version

Part number	w	f	a	d	l ₂	l ₅	t _{max}	D _{min}	Carbide grades					
									MG12	TN35	TI25	TF45	TH35	
R/LU110.0046.1.0	.046										▲/			
R/LU110.0062.1.0	.062										▲/▲			
R/LU110.0078.1.0	.078	.236	.370	.197	.394	1.575	.157	.394			▲/Δ			
R/LU110.0094.1.0	.094										▲/			
R/LU110.0125.1.0	.125										▲/			
R/LU110.0046.3.0	.046										▲/			
R/LU110.0062.3.0	.062										▲/			
R/LU110.0078.3.0	.078										▲/			
R/LU110.0094.3.0	.094	.236	.370	.197	.787	1.969	.157	.394			▲/Δ			
R/LU110.0125.3.0	.125										▲/			
R/LU110.0250.3.0	.250										▲/			
▲ on stock Δ 4 weeks ● main recommendation ○ alternative recommendation □ uncoated grades ■ coated grades ■ brazed/Cermet										P		●		
										M		●		
										K		●		
										S		●		
										N		●		
										H				

Dimensions in inch

State R or L version

Carbide grades

High polish turning with
diamond tools type 105 and S117



H10
technische Diamanten

For further information please see HORN catalog "CARBIDE GROOVING TOOLS".

GROOVING (internal) $\geq \text{Ø} .315''$



B

INSERT Type

U110

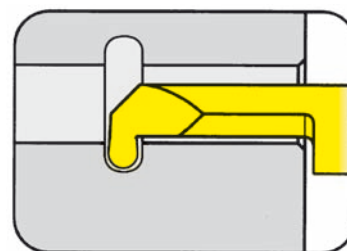

Bore Ø from $.315''$
 Depth of groove up to $.110''$

for use with Toolholder

Type BU110
 B110
 B110C
 VDI

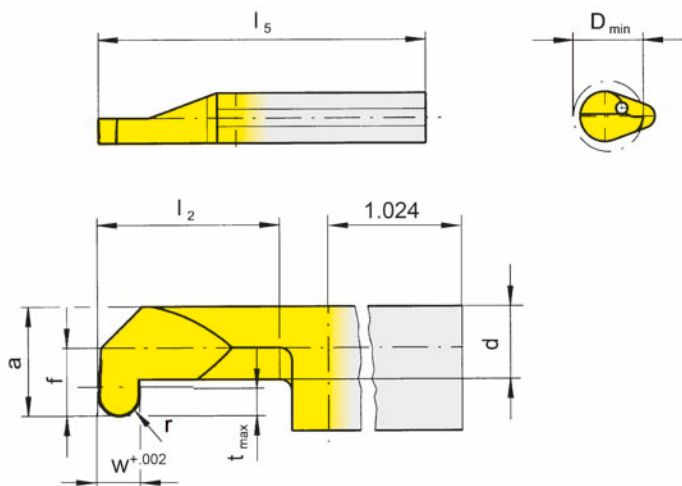

R = right hand version shown

L = left hand version

Full radius

Part number	w	f	a	d	l ₂	l ₅	t _{max}	D _{min}	r	Carbide grades				
										MG12	TN35	TI25	TF45	TH35
R/LU110.3162.1.8	.062								.031			▲▲		
R/LU110.4794.1.8	.094	.157	.291	.165	.394	1.575	.110	.315	.047			▲▲		
R/LU110.6212.1.8	.125								.062			▲▲		
R/LU110.3162.3.8	.062								.031			▲▲		
R/LU110.4794.3.8	.094	.157	.291	.165	.787	1.969	.110	.315	.047			▲/Δ		
R/LU110.6212.3.8	.125								.062			▲/		
R/LU110.3162.5.8	.062								.031			▲/		
R/LU110.4794.5.8	.094	.157	.291	.165	1.181	2.362	.110	.315	.047			▲/		
R/LU110.6212.5.8	.125								.062			▲/		
R/LU110.3162.7.8	.062								.031			▲/		
R/LU110.4794.7.8	.094	.157	.291	.165	1.575	2.756	.110	.315	.047			▲/		
R/LU110.6212.7.8	.125								.062			▲/		

- ▲ on stock Δ 4 weeks
- main recommendation
- alternative recommendation
- uncoated grades
- coated grades
- brazed/Cermet

Dimensions in inch
 State R or L version

P			●	
M			●	
K			●	
S			●	
N			●	
H				

Carbide grades

GROOVING (internal) $\geq \text{Ø} .394''$



INSERT Type

U110

B

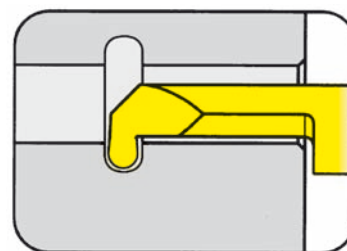

Bore Ø from $.394''$
Depth of groove up to $.157''$

for use with Toolholder

Type BU110
B110
B110C
VDI

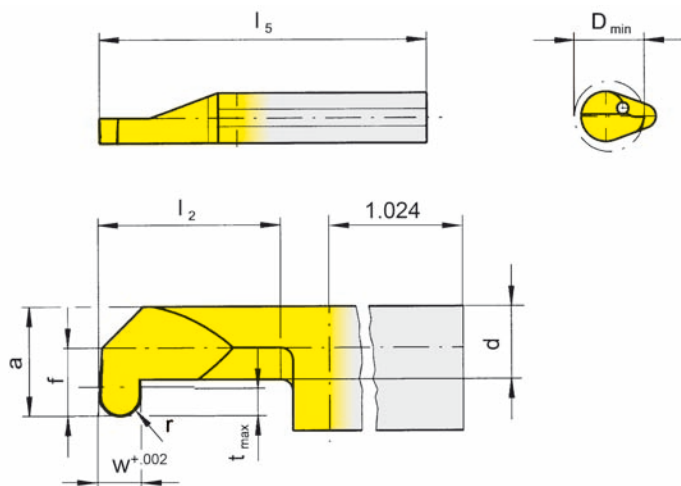

R = right hand version shown

L = left hand version

Full radius

Part number	w	f	a	d	l ₂	l ₅	t _{max}	D _{min}	r	Carbide grades				
										MG12	TN35	TI25	TF45	TH35
R/LU110.3162.1.0	.062								.031			▲/▲		
R/LU110.4794.1.0	.094	.236	.370	.197	.394	1.575	.157	.394	.047			▲/		
R/LU110.6212.1.0	.125								.062			▲/		
R/LU110.3162.3.0	.062								.031			▲/		
R/LU110.4794.3.0	.094	.236	.370	.197	.787	1.969	.157	.394	.047			▲/Δ		
R/LU110.6212.3.0	.125								.062			▲/		
R/LU110.3162.5.0	.062								.031			▲/▲		
R/LU110.4794.5.0	.094	.236	.370	.197	1.181	2.362	.157	.394	.047			▲/▲		
R/LU110.6212.5.0	.125								.062			▲/		
R/LU110.3162.7.0	.062								.031			▲/		
R/LU110.4794.7.0	.094	.236	.370	.197	1.575	2.756	.157	.394	.047			▲/▲		
R/LU110.6212.7.0	.125								.062			▲/		
										P		•		
										M		•		
										K		•		
										S		•		
										N		•		
										H				

- ▲ on stock Δ 4 weeks
- main recommendation
- o alternative recommendation
- uncoated grades
- coated grades
- brazed/Cermet

Dimensions in inch

State R or L version

Carbide grades

FACE GROOVING



B

TOOLHOLDER Type

BU110

with through coolant supply

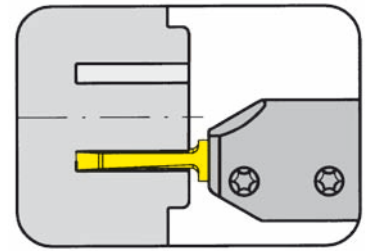

from outer groove \varnothing	.787"
Depth of groove up to	1.181"
Width of groove up to	.118"

for use with Insert

Type A110

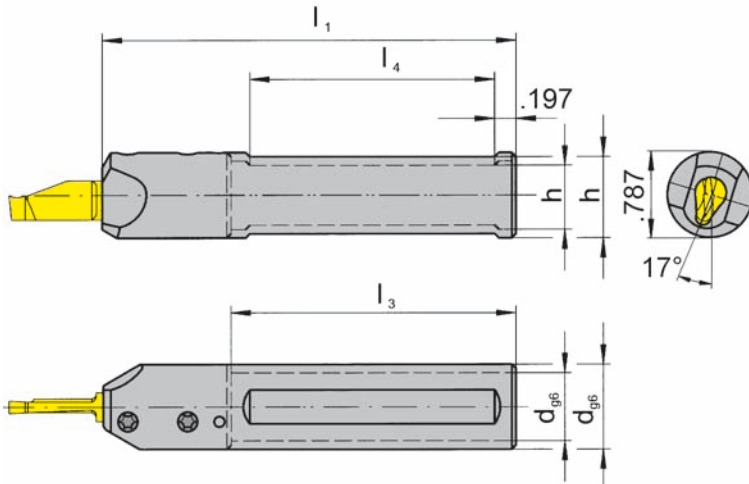

R = right hand version shown

L = left hand version

Part number	d	l_1	h	l_3	l_4
R/LBU110.0625.16.2	.625	3.397	.551	2.756	2.165
R/LBU110.0750.16.2	.750	3.397	.709	-	2.165

State R or L version

Dimensions in inch

Further sizes upon request

Spare parts

Toolholder	Screw	TORX PLUS® Wrench
R/LBU110.0...	6.075T15P	T15PQ

B22

TOOLHOLDER Type

B110

with through coolant supply

from outer groove Ø	.787" (20.0 mm)
Depth of groove up to	1.181" (30.0 mm)
Width of groove up to	.118" (3.0 mm)

Extended depth of insert seat

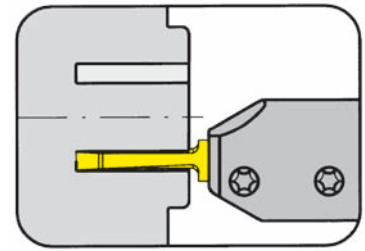

for use with Insert

Type A110

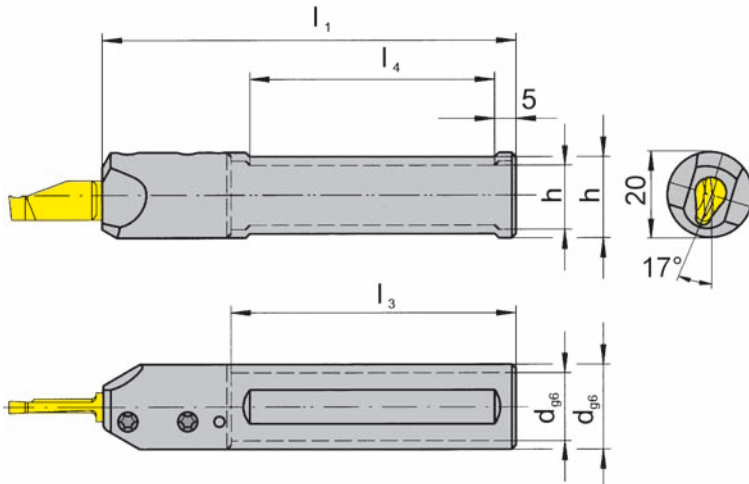

R = right hand version shown

L = left hand version

Part number	d	l ₁	h	l ₃	l ₄
R/LB110.0016.16.2	16	100	14	70	55
R/LB110.0020.16.2	20	100	18	-	55

State R or L version

Dimensions in mm

Further sizes upon request

Spare parts

Toolholder	Screw	TORX PLUS® Wrench
R/LB110.00...	6.075T15P	T15PQ

FACE GROOVING



B

INSERT Type

A110

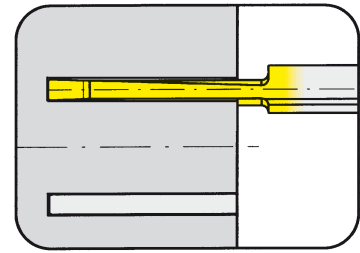

from outer groove \varnothing .787"
 Depth of groove up to 1.181"
 Width of groove up to .118"

for use with Toolholder

Type B110...16.2
 BU110...16.2

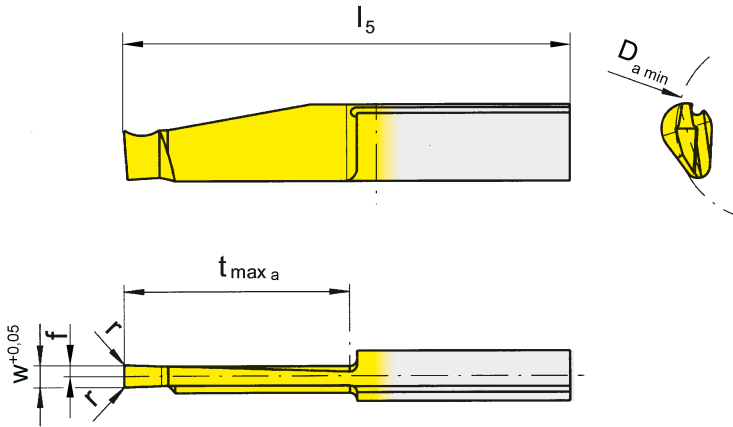

L = left hand version shown

R = right hand version

Part number	w	f	l ₅	t _{max a}	D _{a min}	r	Carbide grades				
							MG12	TN35	TI25	TF45	TH35
R/LA110.2030.3.0	.118	.059	1.969	.787	.787	.008		▲/▲	▲/▲		▲/▲
R/LA110.2030.5.0			2.362	1.181			▲/▲	▲/▲		▲/▲	
R/LA110.5030.3.0	.118	.059	1.969	.787	1.969	.008			▲/▲		
R/LA110.5030.5.0			2.362	1.181			▲/▲	▲/▲			
							P	•	•		•
							M	•	•		•
							K	•	•		•
							S	•	•		•
							N	•	•		•
							H				

- ▲ on stock Δ 4 weeks
- main recommendation
- o alternative recommendation
- uncoated grades
- coated grades
- brazed/Cermet

Dimensions in inch

State R or L version

Note:

Use insert RA110 in toolholder RB110
 Use insert LA110 in toolholder LB110

Face grooving with full width of the full depth only possible between D_{amin} .787" - 1.969".

FACE GROOVING



B

INSERT Type

A110

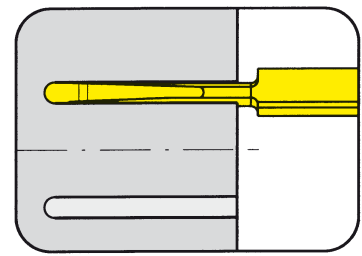

from outer groove \varnothing .787"
 Depth of groove up to 1.181"
 Width of groove up to .118"

for use with Toolholder

Type B110...16.2
 BU110...16.2

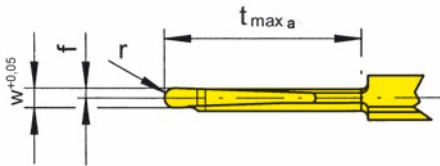
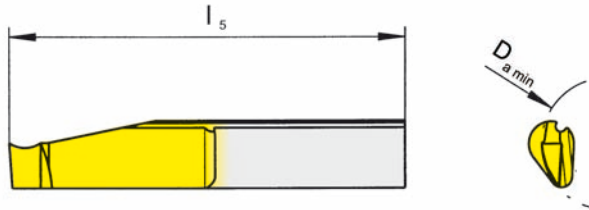

L = left hand version shown

R = right hand version

Full radius

Part number	w	f	l ₅	t _{max a}	D _{a min}	r	MG12	TN35	TI25	TF45	TH35
							R/LA110.2030.15.5.0	.118	.059	2.362	1.181
▲ on stock Δ 4 weeks							P	●	○	○	○
● main recommendation							M	●	○	○	○
○ alternative recommendation							K	●	○	○	○
□ uncoated grades							S	●	○	○	○
■ coated grades							N	●	○	○	○
■ brazed/Cermet							H	●	○	○	○

Carbide grades

Dimensions in inch

State R or L version

Note:

Use insert RA110 in toolholder RB110
 Use insert LA110 in toolholder LB110

Face grooving with full width of the full depth only possible between D_{amin} .787" - 1.969".